

Liz Alpert Fay for Fairfield Processing Corp.

House Pillow / Hand Appliqué

This pillow was designed as a quick, fun project. It is perfect for those interested in learning the technique of hand appliqué. Using felt eliminates turning under rough edges, and enables you to finish this project in just a few hours. It is a great project to do with a child, or for a child.

I encourage anyone learning this technique to follow my design if they wish, and then go ahead and create their own design. By using a really simple drawing done by a child, a very special keepsake can be created. Since the stitches used are also very simple, it could also be the perfect opportunity to teach a child how to sew.

Before starting this project, please print two copies of the house template from your computer.



MATERIALS:

- 15" square of dark red felt for pillow top
- 15" square of plaid corduroy for pillow back
- Scrap pieces of felt (bright red, green, blue, turquoise, black, white, gray, gold, and yellow)
- Pearl cotton or embroidery thread to match each color listed above.
- 1 tube of blue green bugle beads
- Dark red thread to match fabric on pillow top
- 1 package of assorted chenille or darning needles
- 2 copies of house design template from computer
- Elmer's glue
- 14" "Soft Touch" pillow form

CUTTING:

1. Measure and cut a 15" square of dark red felt for pillow top.
2. Measure and cut 15" square of plaid fabric for pillow back.
3. Using one copy of the design template from the computer, cut out along the outer edge of the entire design.
4. Next cut the pattern piece in half along the dotted line. Use these two pattern pieces to cut out the blue sky and the green grass. The paper may be pinned to the felt and then cut out.
5. Use the other copy of the computer pattern to cut out the rest of the shapes. Pin them to the scraps of felt and cut out.

DIRECTIONS:

1. Place the pieces for the sky and grass in the center of the 15" pillow top. Pin in place.
2. Next place the pieces for the house in top of the sky and grass and pin.
3. Arrange remaining pieces and pin in place.
4. Use the overcast stitch to sew the sky and grass to the backing fabric.
5. Next, using the overcast stitch again, stitch the house, and then the remaining pieces.
6. Use a small decorative running stitch to give texture to the smoke.
7. Sprinkle a few bugle beads around the edge of the appliqué on the dark red background. Arrange until it is pleasing to the eye.
8. Use small pieces of masking tape to hold beads in place while stitching them to the background. Remove tape as you prepare to stitch each bead.
9. When all beads are stitched down, turn top over to the wrong side and put a small dab of glue on all knots made when stitching the beads. The glue will keep the knots from slipping through the felt.
10. When the glue has dried, put right sides together and stitch the front back of the pillow together on three sides using a sewing machine. The stitching should be ½" from the edge of the fabric.
11. Insert pillow form and turn the rough edges in ½". Pin and then stitch the opening closed by hand, using the overcast stitch.

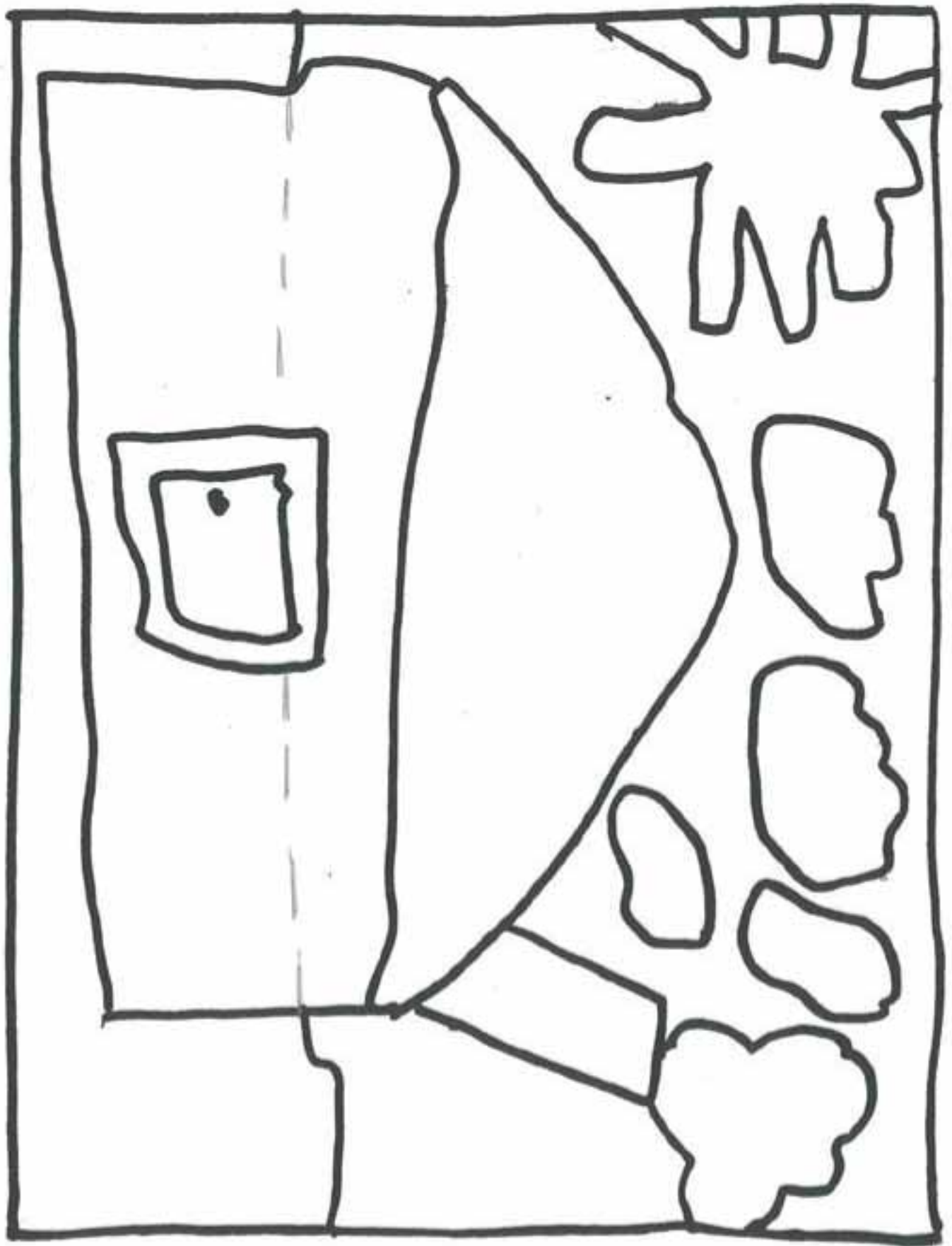



overcast stitch



Running Stitch